

# Meetings & Events

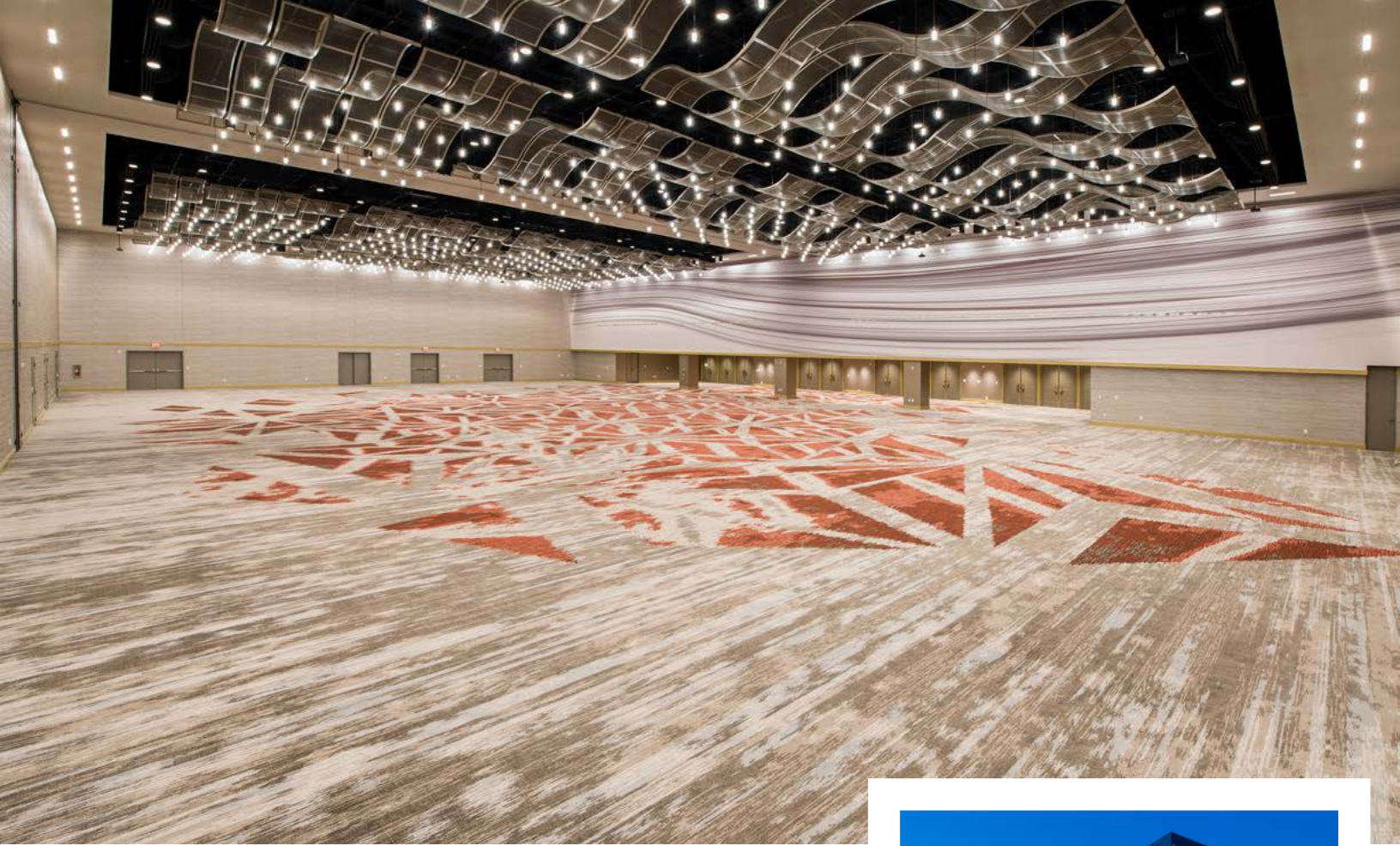

**Hilton**  
ATLANTA





# Custom Spaces. Vibrant City. **Brilliantly Flexible.**

**Experience enhanced flexibility and functionality in Hilton Atlanta's expansive space.**

From the sophisticated, contemporary styling of our inviting guest rooms to the spectacular ambiance of our ballrooms, the Hilton Atlanta and our dedicated event management professionals will help you deliver a fantastic experience. With more than 129,000 sq. ft. of total space, including 60 individual meeting rooms, 23 breakouts and 2 large ballrooms conveniently located on a single floor will fulfill all planners' demands and expectations.

From inspired spaces to incredible restaurants, amenities and service, Hilton Atlanta reflects Atlanta's hospitable spirit.

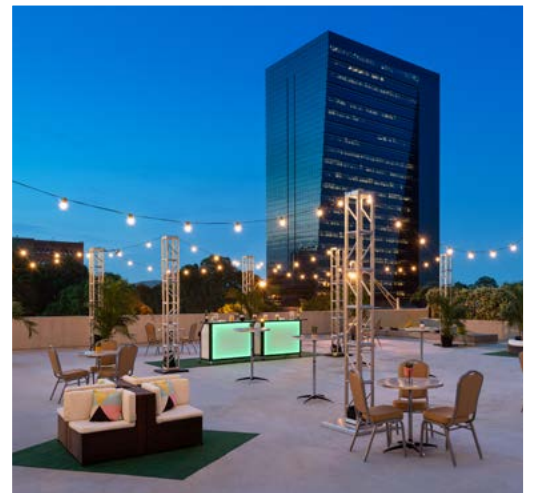

## Fourth Floor

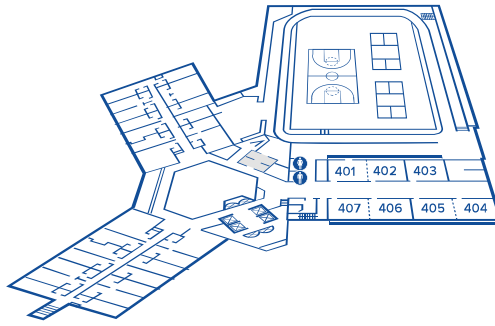

## Third Floor

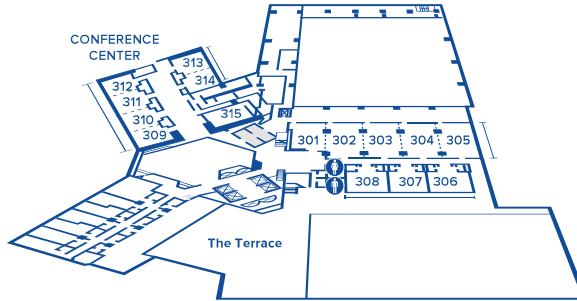

## Second Floor

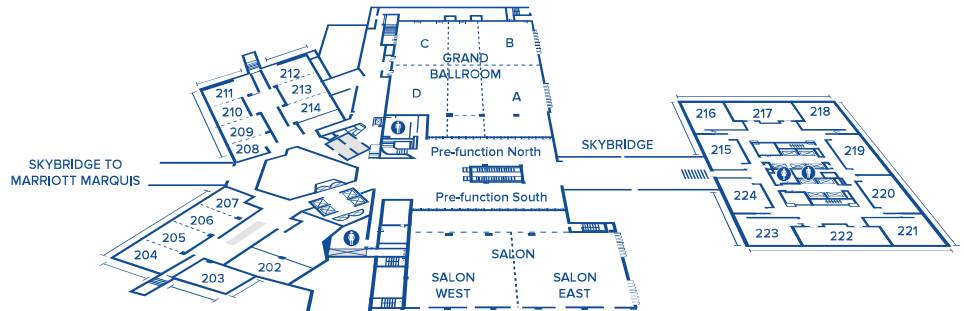

## First Floor

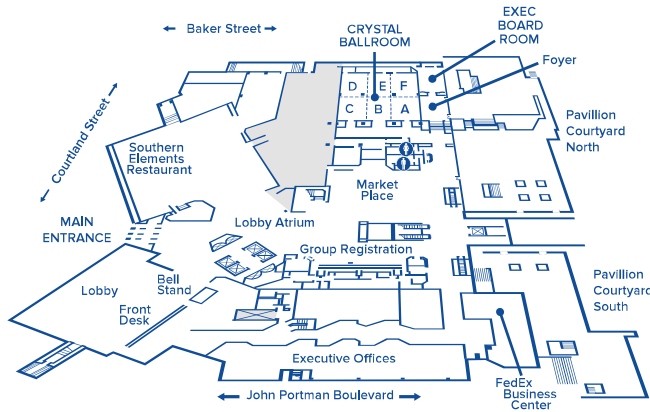

## Galleria



# Galleria

## Meeting Facilities

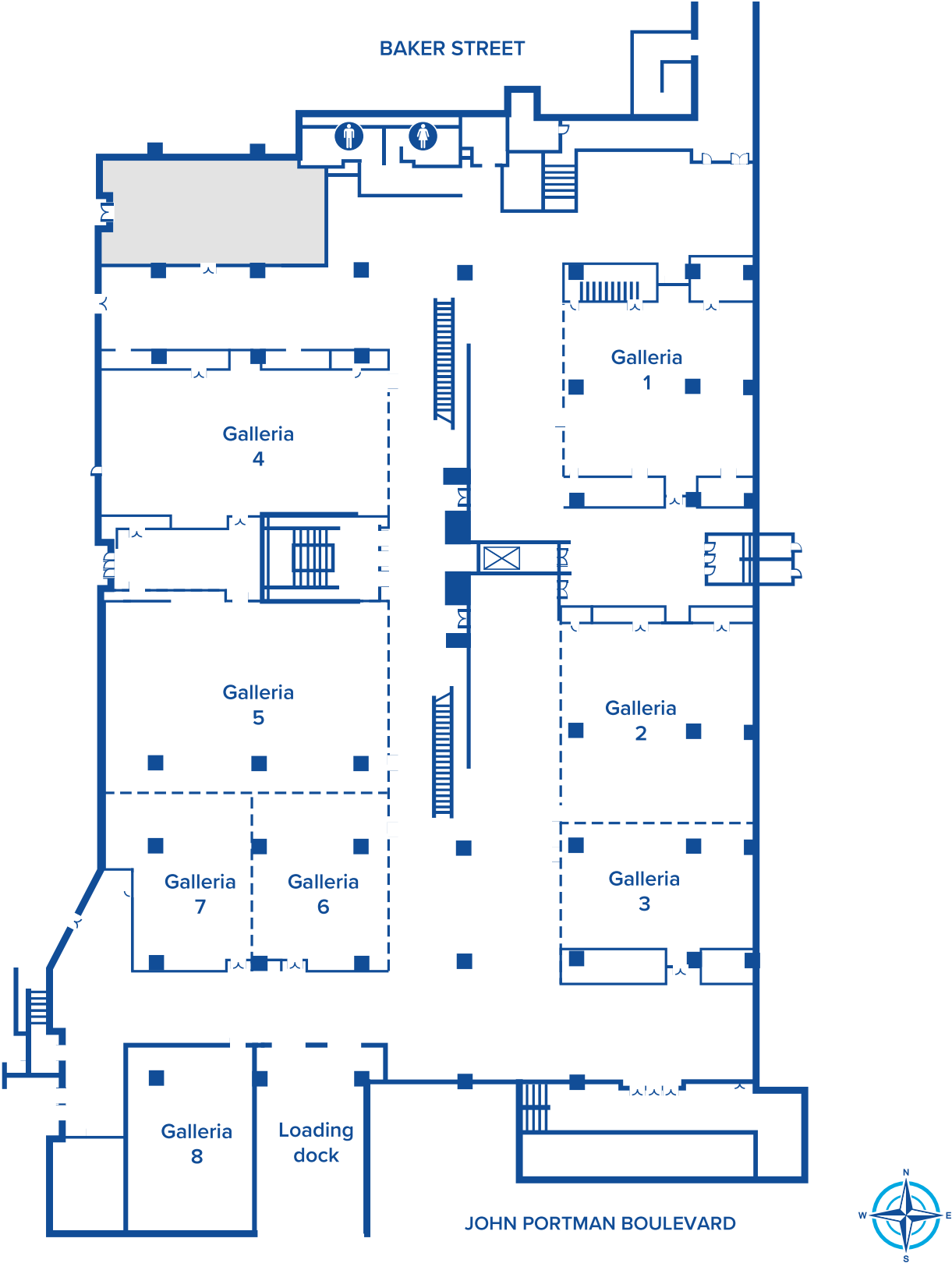



# Galleria

## Capacities

ROOM	DIMENSIONS L x W	SQUARE FEET	CEILING HEIGHT	EXHIBITS 8 x 10'	EXHIBITS 10 x 10'	THEATER	CLASSROOM 2 PER 6'	CLASSROOM 3 PER 6'	5' ROUNDS OF 10	RECEPTION	CONFERENCE
Galleria		39,000		118	102	–	–	–	1,400	2,000	–
Galleria 1	50 x 58'	2,531	8'9"	–	–	240	80	120	200	240	30
Galleria 2	51 x 56'	2,764	8'9"	–	–	270	82	123	220	276	42
Galleria 3	51 x 91'	1,585	8'9"	–	–	130	60	90	120	158	36
Galleria 4	43 x 73'	2,670	8'8"	–	–	272	104	152	230	267	60
Galleria 5	63 x 94'	2,878	8'8"	–	–	300	120	180	220	287	48
Galleria 6	63 x 49'	1,600	8'9"	–	–	144	46	69	110	160	36
Galleria 7	64 x 49'	1,509	8'9"	–	–	120	46	69	110	150	36
Galleria 8	34 x 51'	1,615	8'11"	–	–	174	52	78	100	100	30
Galleria 2 & 3	51 x 92'	4,349	8'9"	–	–	450	140	210	360	400	72
Galleria 5, 6, & 7	64 x 98'	5,987	8'9"	–	–	570	232	348	440	690	–
Galleria 6 & 7	64 x 94'	3,109	8'9"	–	–	260	90	135	240	340	72

Meeting space capacities factor in minimal audio visual and facilitator setup. Reception numbers allow for placement of bars, cocktail rounds, food stations and experience of the hotel.

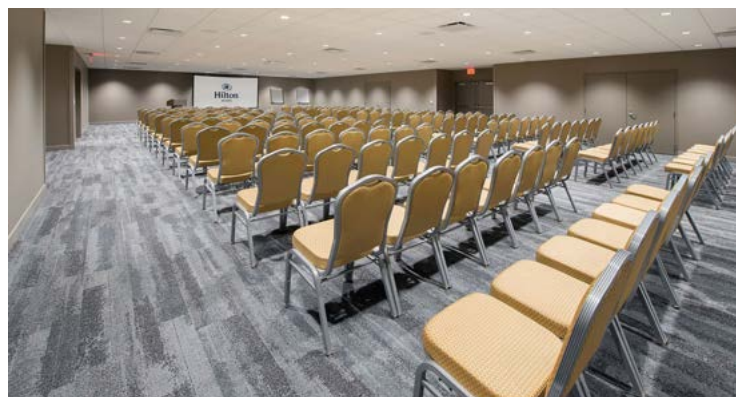

# First Floor

## Meeting Facilities

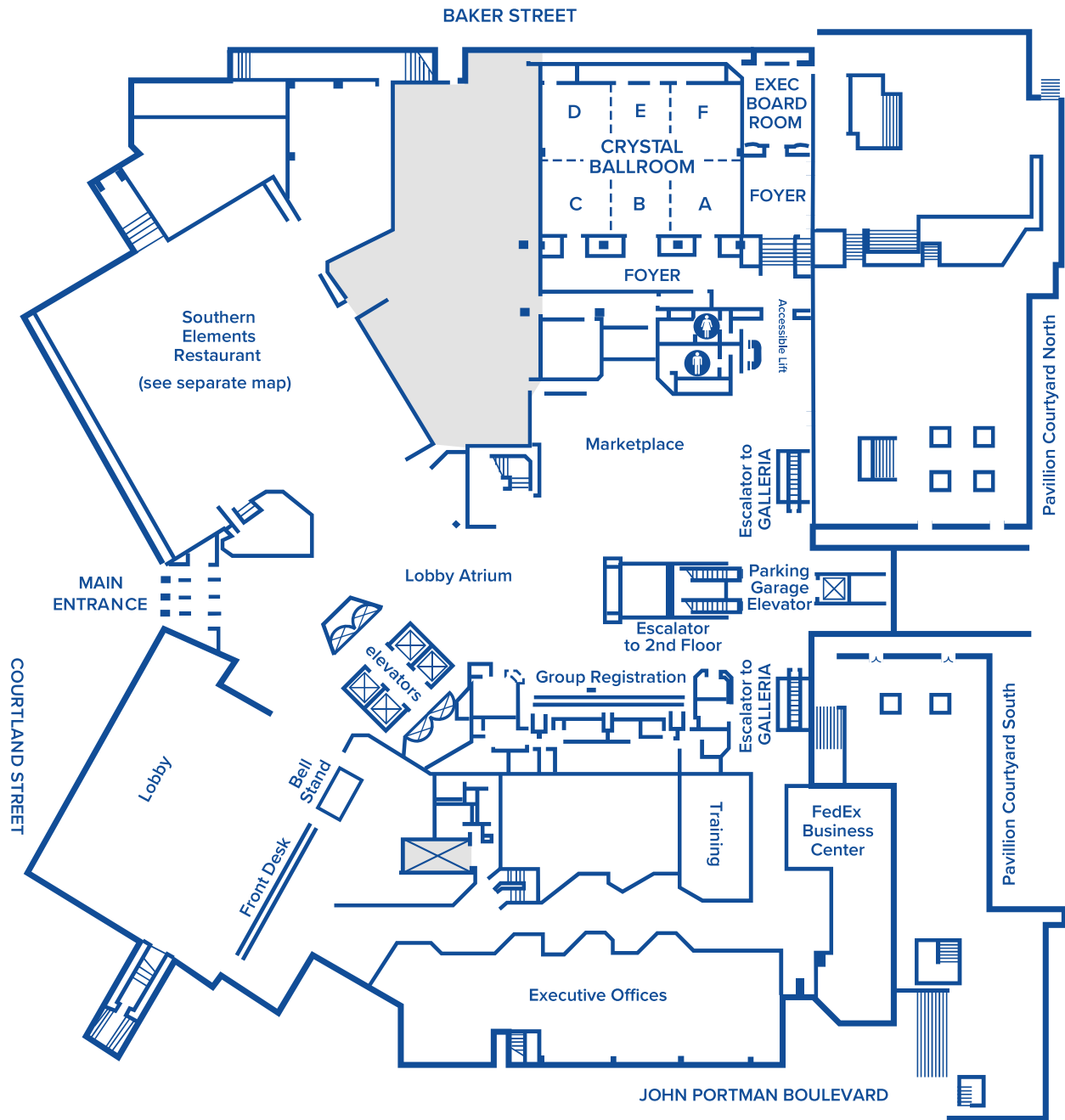

# First Floor

## Capacities

ROOM	DIMENSIONS L x W	SQUARE FEET	CEILING HEIGHT	THEATER	CLASSROOM 2 PER 6'	CLASSROOM 3 PER 6'	5' ROUNDS OF 10	RECEPTION	CONFERENCE
Crystal Ballroom	76 x 55'	4,180	12' 10"	400	124	186	280	350	–
Crystal A	26 x 28'	725	12' 10"	75	30	45	50	75	25
Crystal B	26 x 19'	494	12' 10"	54	20	30	40	50	18
Crystal C	26 x 28'	725	12' 10"	80	24	36	50	75	20
Crystal D	29 x 28'	812	12' 10"	80	24	36	50	75	20
Crystal E	29 x 19'	551	12' 10"	54	16	24	40	50	20
Crystal F	29 x 28'	812	12' 10"	80	30	45	50	75	30
Crystal AB	26 x 47'	1,219	12' 10"	129	50	75	90	125	43
Crystal ABC	26 x 75'	1,944	12' 10"	209	74	111	140	200	63
Crystal AF	55 x 28'	1,537	12' 10"	150	60	90	100	155	55
Crystal ABEF	47 x 55'	2,582	12' 10"	263	96	144	180	230	93
Crystal BC	47 x 26'	1,219	12' 10"	134	44	66	90	125	38
Crystal BE	55 x 19'	1,045	12' 10"	104	36	54	80	110	38
Crystal BCDE	52 x 56'	2,582	12' 10"	268	84	126	180	240	78
Crystal CD	55 x 28'	1,537	12' 10"	160	48	72	100	155	40
Ballroom Foyer	103 x 56'	2,246	–	–	–	–	–	–	–
Executive Boardroom	27 x 32'	864	8'	–	–	–	–	–	15*
Pavilion Courtyard N	137 x 136'	18,632	–	–	–	–	480	550	–
Pavilion Courtyard N	159 x 89'	14,151	–	–	–	–	250	360	–

Meeting space capacities factor in minimal audio visual and facilitator setup. Reception numbers allow for placement of bars, cocktail rounds, food stations and experience of the hotel.  
\*Permanent board table.

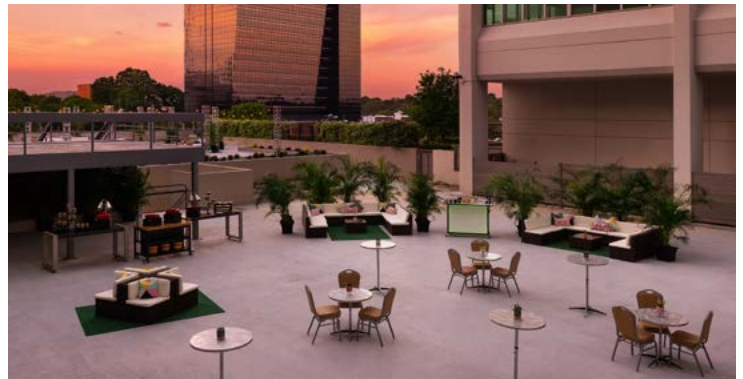

# Second Floor

## Meeting Facilities

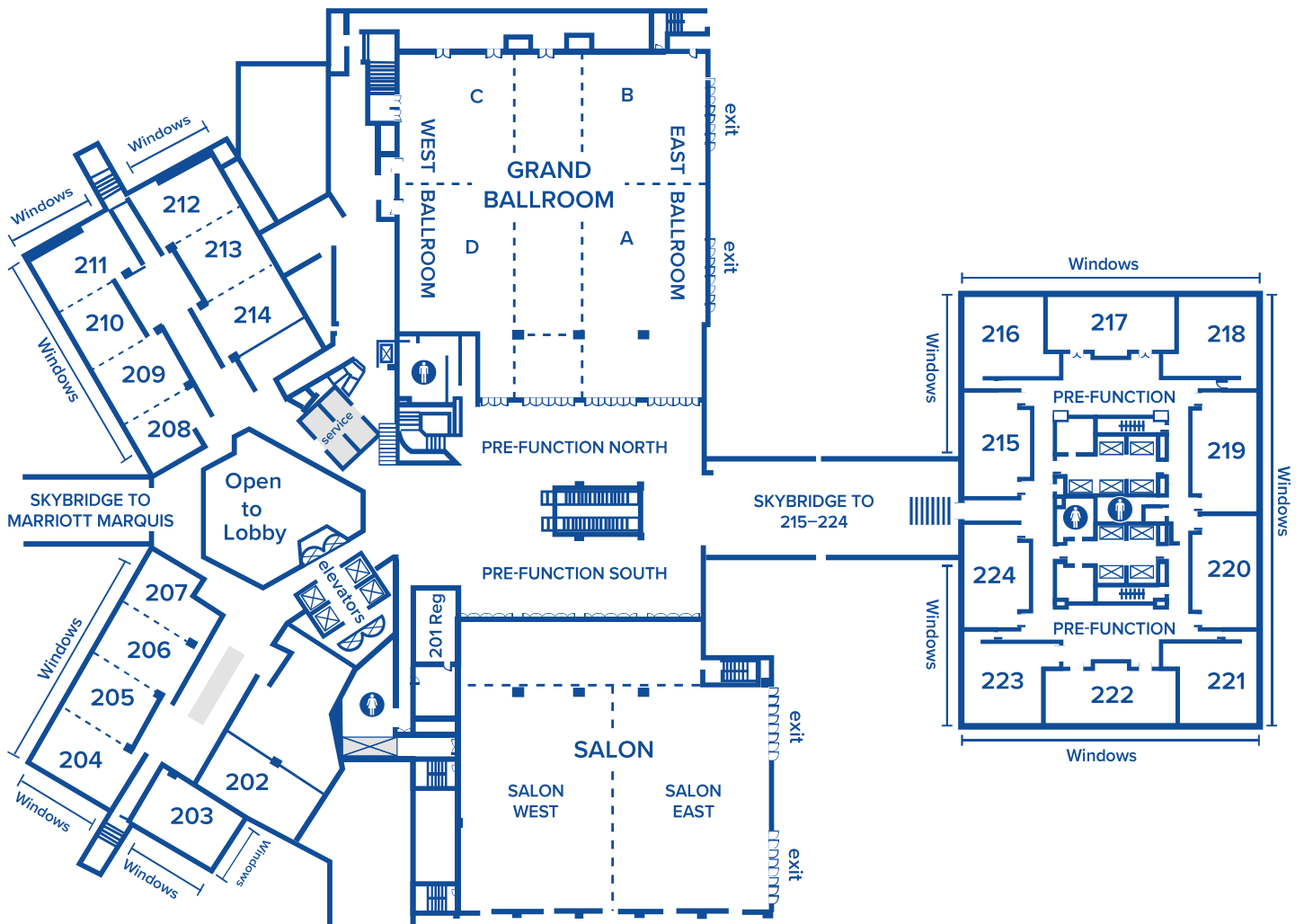



# Second Floor Capacities

ROOM	DIMENSIONS L x W	SQUARE FEET	CEILING HEIGHT	EXHIBITS 8 x 10'	EXHIBITS 10 x 10'	THEATER	CLASSROOM 2 PER 6'	CLASSROOM 3 PER 6'	5' ROUNDS OF 10	RECEPTION	CONFERENCE
Grand Ballroom	145 x 135'	18,576	19.5'	110	89	1,914	760	1,140	1,380	1,800	–
East Ballroom	145 x 55'	7,975	19.5'	40	28	702	240	360	540	750	–
West Ballroom	145 x 53'	6,686	19.5'	37	30	702	240	360	540	750	–
Corridor	145 x 27'	3,915	19.5'	–	–	406	120	180	220	350	–
East and Corridor	145 x 82'	11,890	19.5'	67	54	1,092	360	540	770	1,200	–
West and Corridor	145 x 80'	10,601	19.5'	64	57	1,092	360	540	770	1,200	–
Ballroom A	86 x 55'	4,730	19.5'	–	–	351	140	210	220	350	46
Ballroom B	59 x 55'	3,245	19.5'	–	–	351	140	210	220	350	46
Ballroom C	59 x 53'	3,127	19.5'	–	–	351	140	210	220	350	46
Ballroom D	86 x 53'	3,559	19.5'	–	–	351	140	210	220	350	46
Salon	151 x 98'	17,757	24'	90	75	1,656	680	1,020	1,120	1,600	–
Salon East	97 x 73'	7,471	24'	44	37	828	340	510	560	750	–
Salon West	97 x 73'	7,471	24'	46	38	828	340	510	560	750	–
201 Reg	16 x 213'	336	11'	–	–	–	–	–	–	–	12
202	45 x 25'	1,125	8'6"	–	–	130	44	66	80	130	40
203	40 x 26'	1,040	9'10"	–	–	110	40	60	80	110	34
204	40 x 26'	1,040	9'10"	–	–	110	40	60	80	110	34
205	31 x 27'	835	9'10"	–	–	80	26	39	60	80	28
206	35 x 27'	945	9'10"	–	–	90	30	45	60	90	28
207	39 x 25'	765	9'10"	–	–	70	20	30	40	70	24
208	34 x 25'	740	9'10"	–	–	70	20	30	40	70	24
209	34 x 27'	810	9'10"	–	–	80	26	39	70	80	28
210	34 x 27'	810	9'10"	–	–	80	26	39	70	80	28
211	40 x 24'	960	9'10"	–	–	110	40	60	80	110	34
212	38 x 25'	950	9'10"	–	–	110	40	60	80	110	34
213	30 x 27'	810	9'10"	–	–	80	26	39	60	80	28
214	34 x 25'	850	9'10"	–	–	90	30	45	60	90	28
204-205	71 x 53'	1,875	9'10"	–	–	190	66	99	150	190	54
204-205-206	106 x 80'	2,820	9'10"	–	–	280	96	144	220	280	72
204-205-206-207	145 x 25'	3,585	9'10"	–	–	350	116	174	270	350	90
205-206	66 x 27'	1,780	9'10"	–	–	170	56	84	140	170	54
205-206-207	105 x 25'	2,545	9'10"	–	–	240	76	114	190	240	72
206-207	74 x 25'	1,710	9'10"	–	–	160	50	85	120	160	52
208-209	68 x 25'	1,550	9'10"	–	–	150	46	69	120	150	52
208-209-210	102 x 25'	2,360	9'10"	–	–	230	72	108	190	230	72
208-209-210-211	142 x 24'	3,320	9'10"	–	–	340	112	168	270	340	90
209-210	68 x 27'	1,620	9'10"	–	–	160	52	78	140	160	54
209-210-211	108 x 24'	2,580	9'10"	–	–	270	92	138	220	270	72
210-211	74 x 24'	1,770	9'10"	–	–	190	66	99	160	190	54
212-213	68 x 25'	1,760	9'10"	–	–	190	66	99	150	190	54
212-213-214	102 x 25'	2,610	9'10"	–	–	280	96	144	210	280	72
213-214	64 x 25'	1,600	9'10"	–	–	170	56	84	140	170	56
215	52 x 19'	979	8'10"	–	–	110	32	48	80	100	36
216	40 x 23'	1,059	8'10"	–	–	105	40	60	80	110	30
217	39 x 26'	1,118	8'10"	–	–	110	40	60	80	120	30
219	40 x 23'	1,059	8'10"	–	–	105	40	60	80	110	30
219	59 x 19'	1,158	8'10"	–	–	110	32	48	80	140	36
220	55 x 19'	1,137	8'10"	–	–	110	32	48	80	120	36
221	40 x 23'	1,059	8'10"	–	–	105	40	60	80	110	30
222	39 x 26'	1,118	8'10"	–	–	110	40	60	80	120	30
223	40 x 23'	1,059	8'10"	–	–	105	40	60	80	110	30
224	52 x 19'	979	8'10"	–	–	110	32	48	80	100	36

Meeting space capacities factor in minimal audio visual and facilitator setup. Reception numbers allow for placement of bars, cocktail rounds, food stations and experience of the hotel.

# Third Floor

## Meeting Facilities

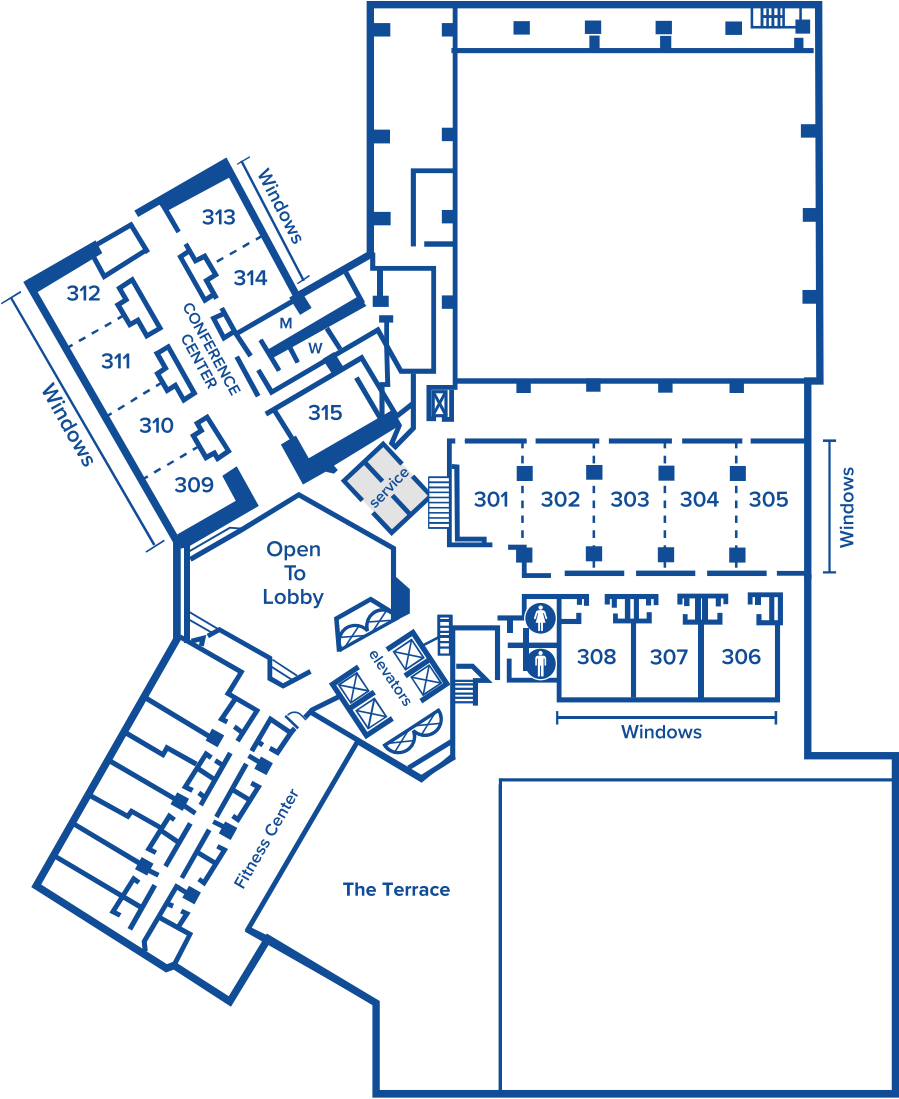

# Third Floor

## Capacities

ROOM	DIMENSIONS L x W	SQUARE FEET	CEILING HEIGHT	THEATER	CLASSROOM 2 PER 6'	CLASSROOM 3 PER 6'	5' ROUNDS OF 10	RECEPTION	CONFERENCE
301	37 x 23'	851	9' 10"	90	34	51	60	80	34
302	48 x 30'	1,440	9' 10"	120	46	69	90	130	40
303	48 x 24'	1,104	9' 10"	110	44	66	80	105	40
304	48 x 30'	1,440	9' 10"	120	46	69	80	130	40
305	48 x 24'	1,152	9' 10"	110	44	66	80	105	40
306	26 x 23'	598	10' 8"	50	18	27	40	50	26
307	26 x 23'	598	10' 8"	50	18	27	40	50	26
308	26 x 23'	598	10' 8"	50	18	27	40	50	26
309	26 x 24'	646	10' 8"	65	24	36	40	65	20
310	27 x 24'	667	10' 8"	70	24	36	40	70	20
311	27 x 24'	667	10' 8"	70	24	36	40	70	20
312	26 x 24'	614	10' 8"	55	20	30	30	50	20
313	26 x 25'	652	10' 8"	65	24	36	40	65	20
314	26 x 25'	646	10' 8"	65	24	36	40	65	20
315	35 x 25'	913	10' 8"	56	26	39	50	65	24
301-302	85 x 23'	2,291	9' 10"	170	58	97	140	210	54
301-302-303	133 x 23'	3,395	9' 10"	210	92	132	230	315	72
301-302-303-304	181 x 23'	4,835	9' 10"	310	128	186	320	445	90
301-302-303-304-305	229 x 23'	5,987	9' 10"	370	160	218	410	550	105
302-303	96 x 24'	2,544	9' 10"	190	56	84	170	235	54
302-303-304	144 x 24'	3,984	9' 10"	250	100	132	260	365	72
302-303-304-305	192 x 24'	5,136	9' 10"	310	132	186	350	470	90
303-304	96 x 24'	2,544	9' 10"	190	56	84	180	235	54
303-304-305	144 x 24'	3,696	9' 10"	220	100	143	270	340	72
304-305	96 x 24'	2,592	9' 10"	190	108	132	180	235	54
309-310	53 x 24'	1,313	10' 8"	135	48	72	100	135	40
309-310-311	80 x 24'	1,980	10' 8"	205	72	108	160	205	60
309-310-311-312	106 x 24'	2,594	10' 8"	260	92	138	190	265	80
310-311	54 x 24'	1,334	10' 8"	140	48	72	100	140	40
310-311-312	80 x 24'	1,948	10' 8"	195	68	102	140	200	60
311-312	53 x 24'	1,281	10' 8"	125	44	66	80	120	40
313-314	52 x 25'	1,298	10' 8"	130	48	72	100	130	40

Meeting space capacities factor in minimal audio visual and facilitator setup. Reception numbers allow for placement of bars, cocktail rounds, food stations and experience of the hotel.





# Fourth Floor

## Meeting Facilities

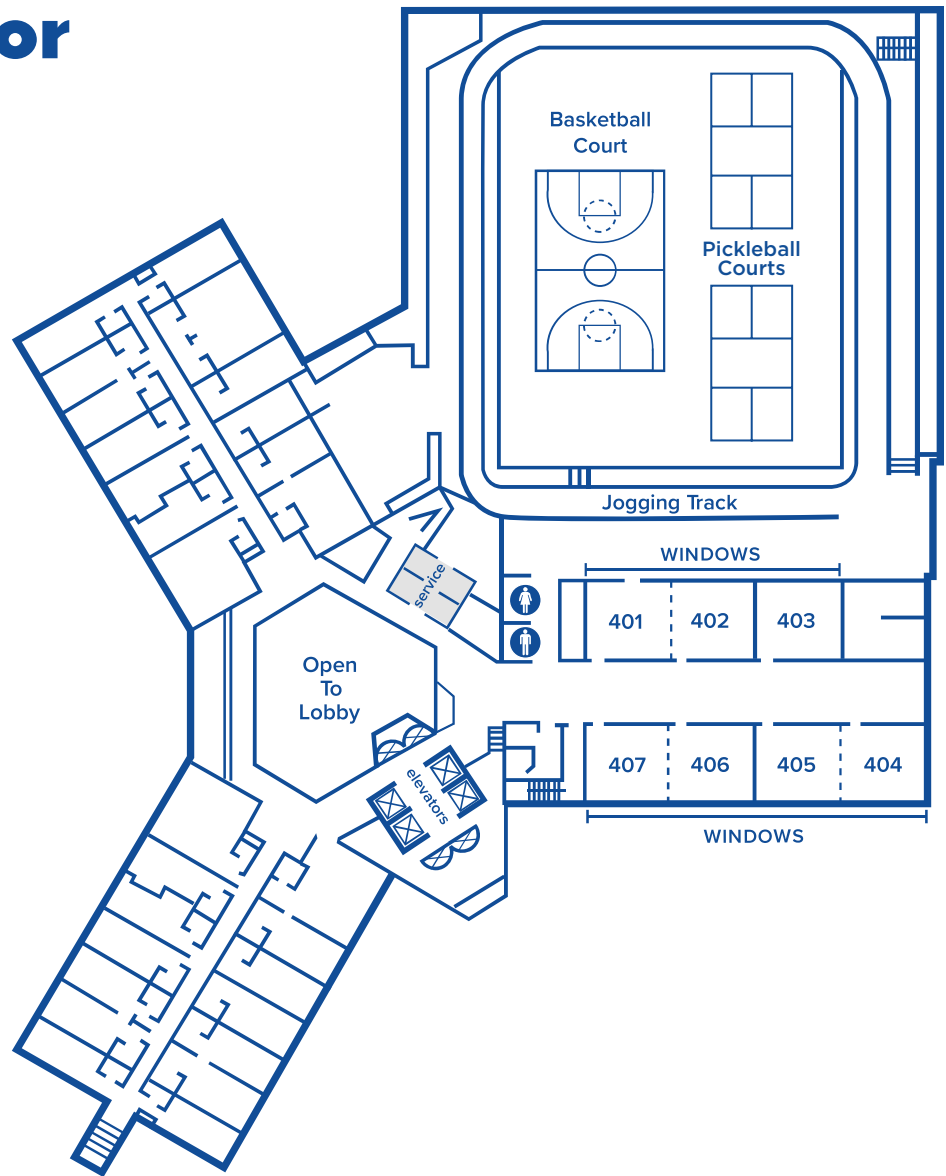

# Fourth Floor

## Capacities



ROOM	DIMENSIONS L x W	SQUARE FEET	CEILING HEIGHT	THEATER	CLASSROOM 2 PER 6'	CLASSROOM 3 PER 6'	5' ROUNDS OF 10	RECEPTION	CONFERENCE
401	25 x 23'	575	9'10"	65	20	30	40	65	24
402	25 x 27'	675	9'10"	75	22	33	50	75	24
403	25 x 27'	675	9'10"	75	22	33	50	75	24
404	28 x 26'	728	9'10"	80	22	33	40	80	24
405	26 x 24'	624	9'10"	70	22	33	40	70	24
406	28 x 26'	728	9'10"	80	22	33	40	80	24
407	26 x 24'	624	9'10"	70	22	33	40	70	24
401-402	50 x 25'	1,240	9'10"	115	42	63	90	115	40
404-405	52 x 26'	1,352	9'10"	115	42	63	90	115	40
406-407	52 x 26'	1,353	9'10"	115	42	63	90	115	40

Meeting space capacities factor in minimal audio visual and facilitator setup. Reception numbers allow for placement of bars, cocktail rounds, food stations and experience of the hotel.



# Nikolai's Roof

**Elegant Surroundings.  
Spectacular Views and  
Attentive Service.  
An Atlanta Tradition.**

On the top floor of Hilton Atlanta, Nikolai's Roof delights guests with stunning views of the Atlanta skyline, masterfully prepared AAA Four Diamond cuisine, impeccable service and an award-winning wine list. Savor house-infused vodkas and a seasonally-inspired menu that features modern American cuisine with a nod to the restaurant's European influences, prepared with ingredients from local purveyors.

The Lounge opens early and serves a variety of premium hand-crafted cocktails.

**Located on the Top Floor of Hilton Atlanta.**  
[nikolaisroofatl.com](http://nikolaisroofatl.com)

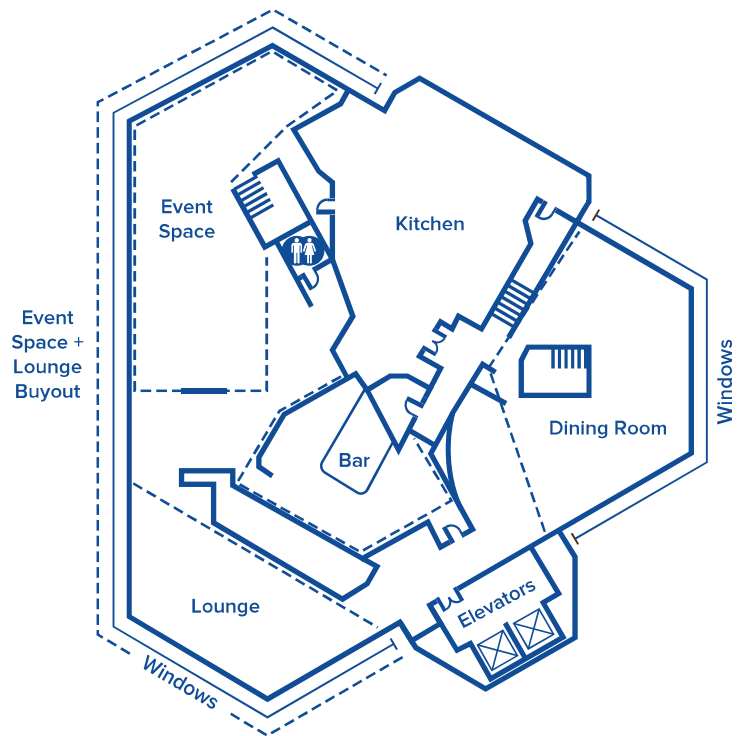

SPACE	CAPACITIES
Dining Room	68
Event Space, Dinner	100
Event Space, Reception	125
Lounge	30-50
Event Space + Lounge (Buyout), Reception	200
Nikolai's Roof Buyout, Reception	300

Capacities take into consideration placement of bars, cocktail rounds, food stations and experience of the hotel.



# Trader Vic's

## Indulge in a Taste of the Tropics.

Escape to Trader Vic's, a tropical retreat located on the lower level of Hilton Atlanta. Enjoy simmering plates of island-inspired cuisine centered around the signature Chinese wood-fired ovens and over 70 specialty libations (including the original Mai Tai).

Trader Vic's brings the Pacific Islands to the city with an unforgettable ambiance that features traditional Tikis, giant blowfish and palm-thatched ceilings.

Located on the Lower Level of Hilton Atlanta.  
[tradervicsatl.com](http://tradervicsatl.com)

SPACE	CAPACITIES
Buyout	225
Deck	24
Garden	46
Puka	48
Samoan	30
Tonga	55

Capacities take into consideration placement of bars, cocktail rounds, food stations and experience of the hotel.

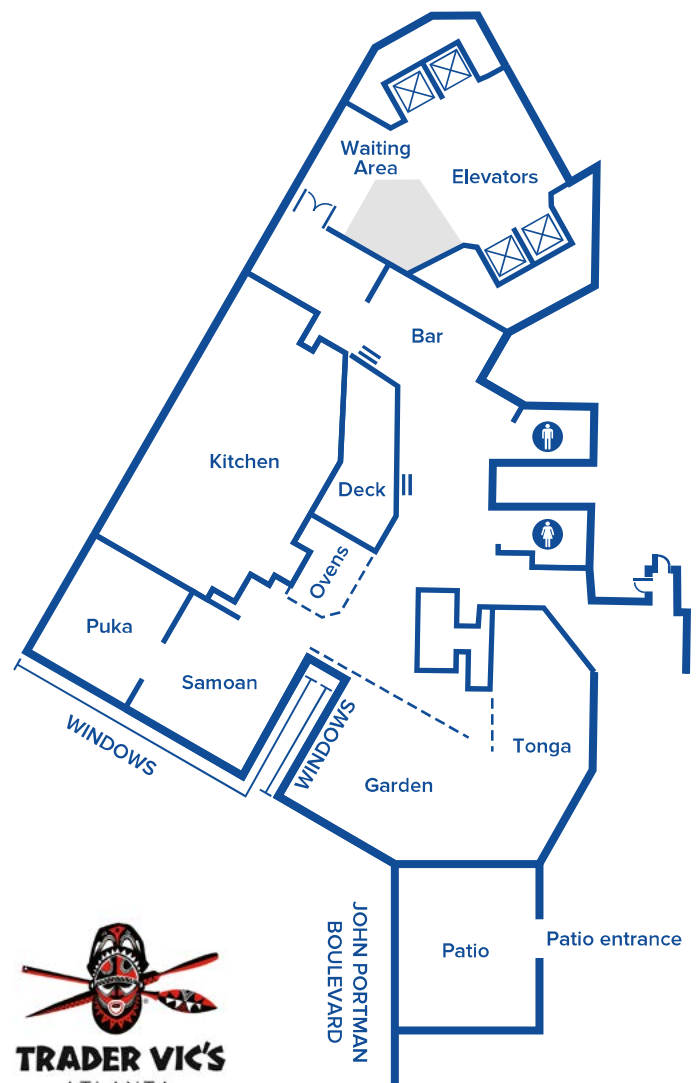





# Southern Elements

**Celebrating current culinary trends from around the region for a tantalizing taste of the South.**

Dine on traditional Southern cuisine with a modern twist. Southern Elements' two semi-private spaces are ideal for small-scale dinners or intimate occasions.

**Located in the Hilton Atlanta Lobby.**

SPACE	CAPACITIES
Dining Room	236
Bar / Lounge	60
Private Room 1	60
Private Room 2	70

Capacities take into consideration placement of bars, cocktail rounds, food stations and experience of the hotel.



## SOUTHERN ELEMENTS





## Hilton Atlanta

255 Courtland Street NE  
Atlanta, Georgia, United States 30303

1.404.659.2000  
HiltonAtlanta.com

 [facebook.com/hiltonatlanta](https://facebook.com/hiltonatlanta)

 [instagram.com/hiltonatlanta](https://instagram.com/hiltonatlanta)

